

ITEM NO.	PART NUMBER	DESCRIPTION	MATERIAL	FINISH	QTY.
1	SS202	TWO ARM FACE MOUNTED S20 SPIDER	GD316 SS	BRUSHED #4	1
2	HB-M16x50	Hex Bolt M16x50	A2-70 (18-8)	EX WORKS	1
3	Hex Nut M16	Hex Nut M16	A2-70 (18-8)	EX WORKS	1
4	SW-M16	LOCK WASHER M16	A2-70 (18-8)	EX WORKS	1
5	HN - M16	WASHER FLAT M16	A2-70 (18-8)	EX WORKS	2

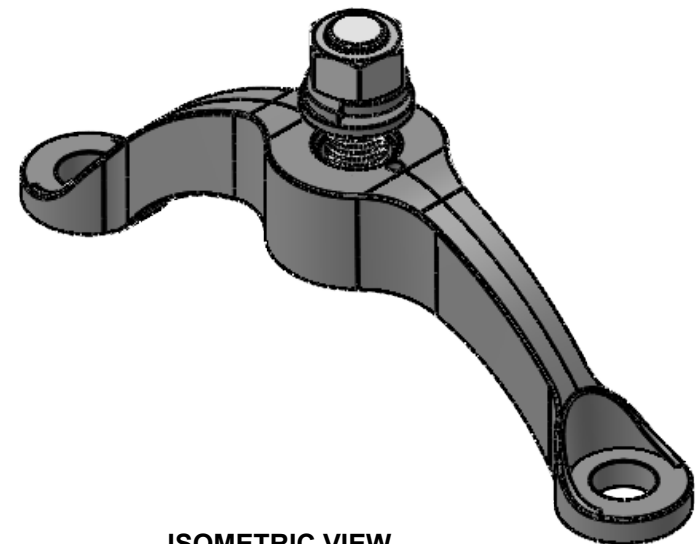
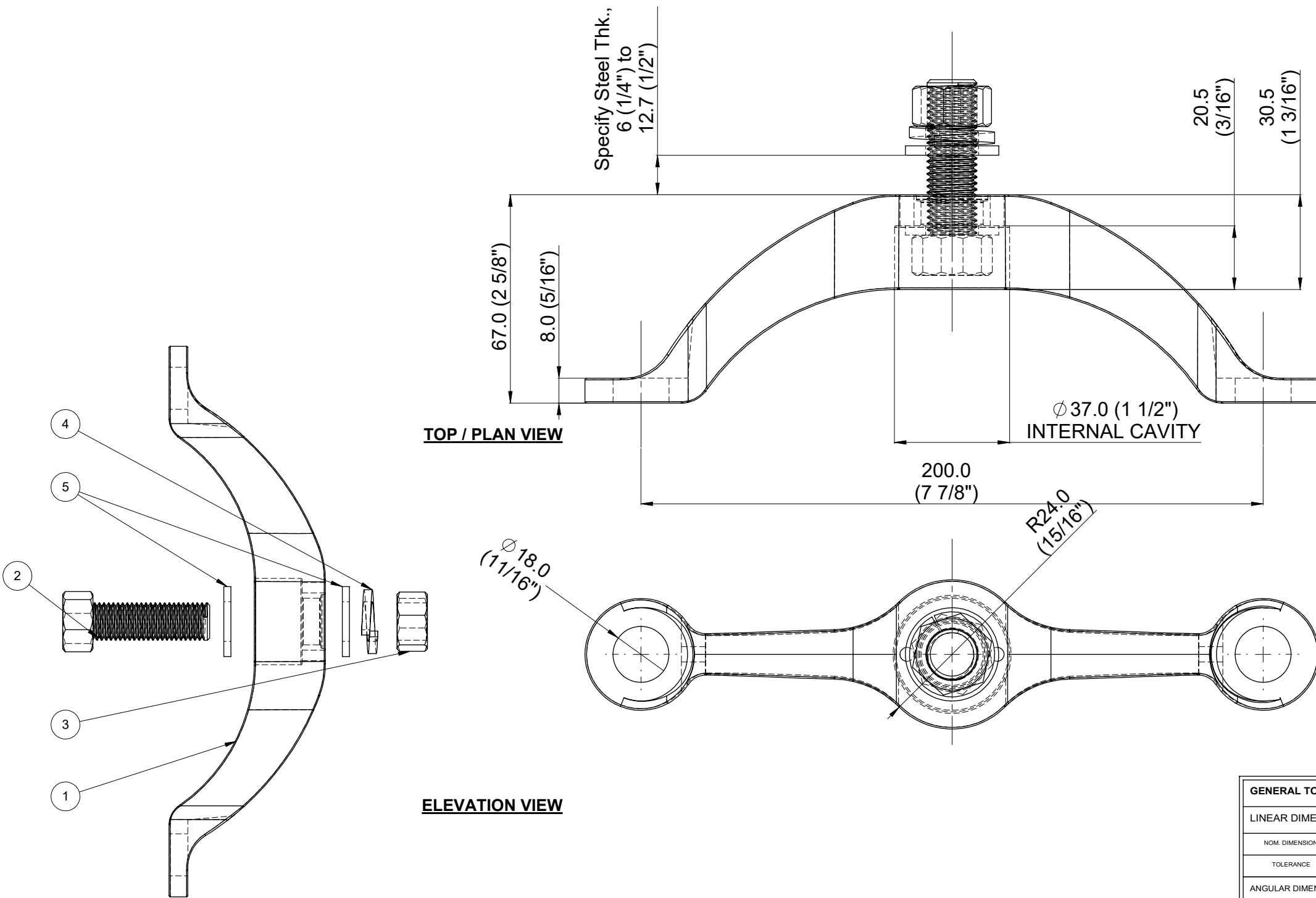

ISOMETRIC VIEW
SCALE 1:2

GENERAL TOLERANCES (mm) UNLESS SPECIFIED								
LINEAR DIMENSION TOLERANCES (ISO 2768 - FINE)								
NOM. DIMENSION	0.5 TO 3	3 TO 6	6 TO 30	30 TO 120	120 TO 400	400 TO 1000	1000 TO 2000	2000 TO 4000
TOLERANCE	±0.05	±0.05	±0.1	±0.15	±0.2	±0.3	±0.5	-
ANGULAR DIMENSION TOLERANCES (ISO 2768 - FINE)					EXT. RADIUS / CHAMFER HEIGHTS (ISO 2768 - FINE)			
NOM. DIMENSION	0 TO 10	10 TO 50	50 TO 120	120 TO 400	NOM. DIMENSION	0.5 TO 3	3 TO 6	OVER 6
TOLERANCE	±1°	±0°30'	±0°20'	±0°10'	TOLERANCE	±0.2	±0.5	±1.0

**** NOTE: SUGGESTED PAIRING - STELLA ARTICULARING BOLTS ****

ASSEMBLY DRAWING - SKU #SS202FTNHH6S013
STRAIGHT TWO ARM FACE MOUNTED S 20 SPIDER - SS202FT:
 100mm [3 15/16"] LONG SPIDER FITTING w/ BRUSHED #4 FINISH
 (INCLUDES M16 HEX BOLT & NUT, FLAT & LOCK WASHERS)

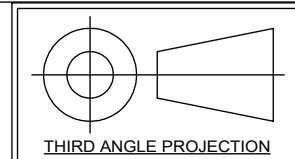

SCALE	1:1
DWG No	SS202FTNHH6S013

