

	Tapered front plate	Flat front plate
Embedded into concrete	ST503T-C	ST503F-C
Penetrated into wood	ST503T-W	ST503F-W
Post mounted	ST503T-S	ST503F-S

REV 1 - Hex bolt changed to socket head cap screw - APR 30-2012
 REV 2 - Loading information added - FEB 14-2013
 REV 3 - NB4-P09.1 changed to 3/8" Lag bolt x 5" lg. - MAR 5-2013
 REV 4 - Notes added & removed - OCT 7-2013

EMBEDDED INTO CONCRETE (STANDARD)
ST503-C

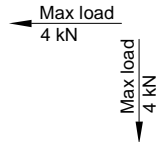

Allowable loading non-factored.
 Anchoring & substrate to be reviewed separately

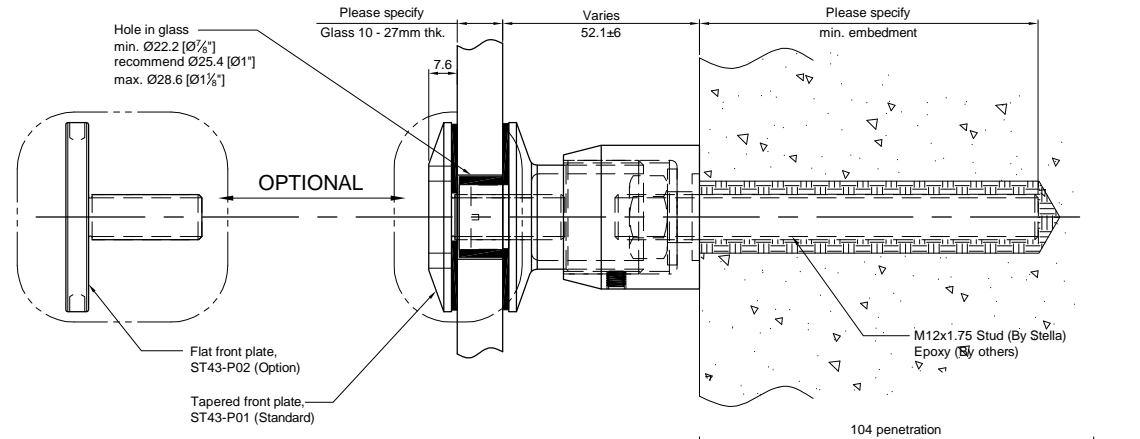

PENETRATED INTO WOOD (OPTION)
ST503-W

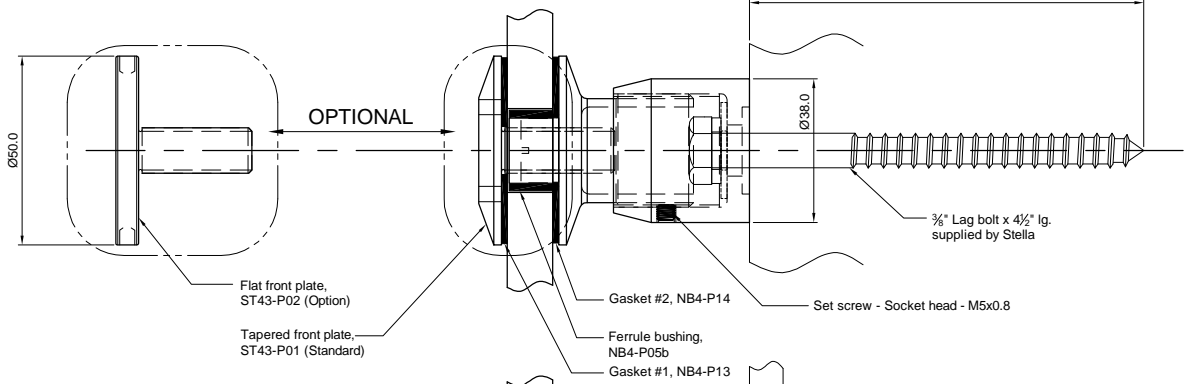

POST MOUNTED (OPTION)
ST503-N (W/ NUTSERT)
ST503-O (W/ DRILL & TAP)
ST503-H (W/ HEXNUT)

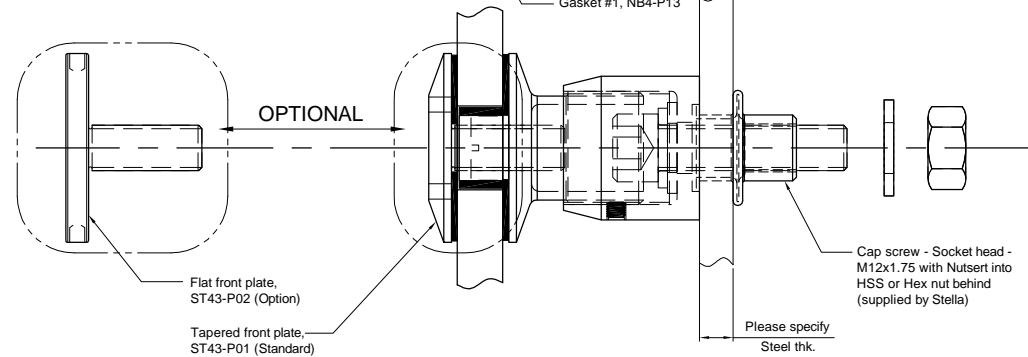

ORDERING INFORMATION

(please check)

Embedded into concrete (std)	
Penetrated into wood (option)	
Post mounted (option)	
Tapered front cap (std)	
Flat front-cap (option)	

Glass thickness ____ mm
 Steel thickness ____ mm

APPROVAL

CUSTOMER APPROVAL

(PLEASE SIGN)

DATE:

DATE

Quantity:
 Material: Grade 316 Stainless steel
 Finish: Fine machined

Hole in glass see above
 Dimensions millimeter unless otherwise shown
 Apply loctite 243 to all threads during assembly
 (To increase curing speed, please apply activator 7649)
 Details are typical and are subject to change to meet project requirement

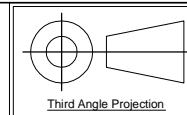

Drawn	Drawn date
JH	SEPT 9-2010
Approved	Approved date
-	-
Scale	Rev.
1:2	4
DWG No	
ST503	

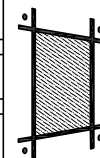

stella

[t] (604) 231 5892
 [f] (604) 231 5893
 [e] info@stellaglasshardware.com

ASSEMBLY DRAWING
ADJUSTABLE STANDOFF